

### Duaceramic® Liners

Duaceramic is a new, dynamic product offered by Bradken's Wear Plate and Block. Duaceramic combines hard alumina ceramic blocks, chemically and mechanically bonded to an impact resistant polyurethane elastomer. Duaceramic is designed for use in the most extreme abrasive environments found in the mining and mineral processing industries.

Duaceramic liners are available in a range of standard thicknesses and shapes. Duaceramic liners can also be customised to provide unique shapes for wear packages. The Duaceramic liners can be manufactured using hexagonal alumina blocks for high abrasion and medium impact or large rectangular alumina ceramic tiles, for extreme abrasion with low impact.

#### Duaceramic Features:

**Maximum Resistance To Abrasion:** The ceramic blocks used in Duaceramic are manufactured from high alumina ceramic to provide maximum resistance to abrasion.

**Multidirectional:** The Duaceramic liners do not require a specific orientation to flow direction.

**Edge Protection:** Leading and trailing edges can be included to protect the ceramic tiles from severe impact on the edges.

**Noise Reduction:** The polyurethane medium not only absorbs impact, but also reduces noise caused by bulk material flow.

**Backing Plate:** A unique, light weight backing plate can be included to provide assistance in the knockout of worn liners.

**Ceramic Locking System:** Each ceramic tile used in the Duaceramic liners comes with a locking mechanism to prevent tile knock out during severe impact.

**Unique Chemical Treatment:** The ceramic tiles in Duaceramic undergo a unique chemical treatment to provide a superior polyurethane to ceramic bond strength.

**Customized Liners:** Duaceramic can be manufactured into a range of complex shapes with angles and bevelled edges.

**Australian made:** Duaceramic is a wholly Australian developed and manufactured product by Bradken.

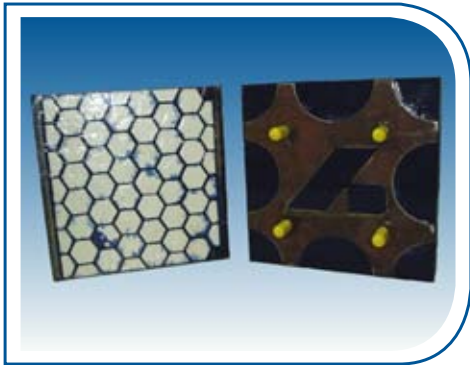

Duaceramic liners with edge protection and backing plate



35mm thick Duaceramic liners for a ship loader

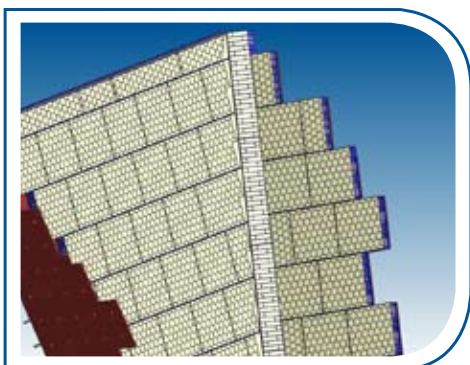

63mm thick Duaceramic chute layout

### Duaceramic® Liners

#### Comparison With A Competitor

Duaceramic offers a superior replacement for competitor ceramic/polymer composites. The following is a comparison between a competitor liner and the equivalent Duaceramic liner:

Feature	Duaceramic	Competitor
Backing Plate (BP)	Optional	Compulsory
Edge Protection	Optional	Optional
Angled & Bevelled Edges	Yes	Yes
Locking Mechanism	Yes	No
Multidirectional	Yes	No
Medium Material	Polyurethane (PU)	Styrene Butadiene Rubber (SBR)

#### Complementary Products & Services

In addition to our Duaceramic liners, Bradken can also provide:

- Wear package design services
- Polyurethane impact liners
- Ceramic to metal fabrications



35mm Duaceramic liners for an apron feeder



Unique Duaceramic light weight backing plate

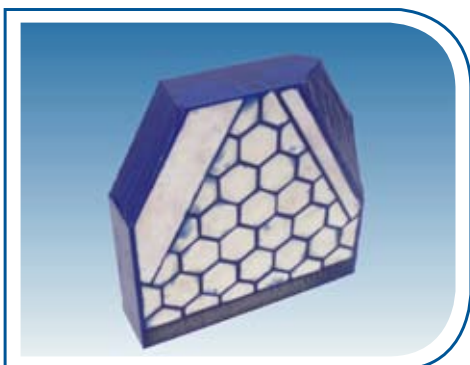

Duaceramic tile showing key design features

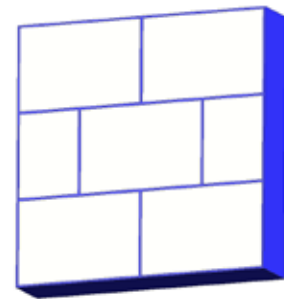
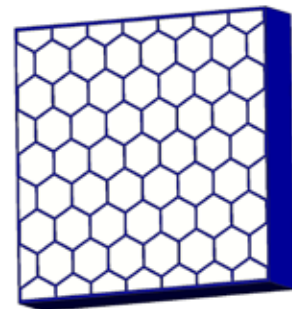
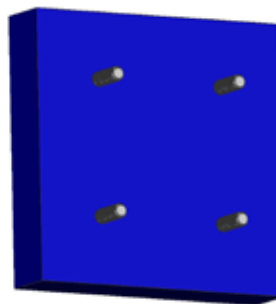

**duaceramic®**

For more information contact Bradken at [wpbsales@bradken.com.au](mailto:wpbsales@bradken.com.au)

3 BKM SP MKT  
Rev. 3  
Issue date – Dec 2008

170 Railway Parade Bassendean WA 6054 Australia  
T +61 8 9449 8300 F +61 8 9449 8334  
W [bradken.com](http://bradken.com)